

# LIVERPOOL EG WHITLAM CENTRE - MAIN HALL - 65m x 36m (Floor Space)

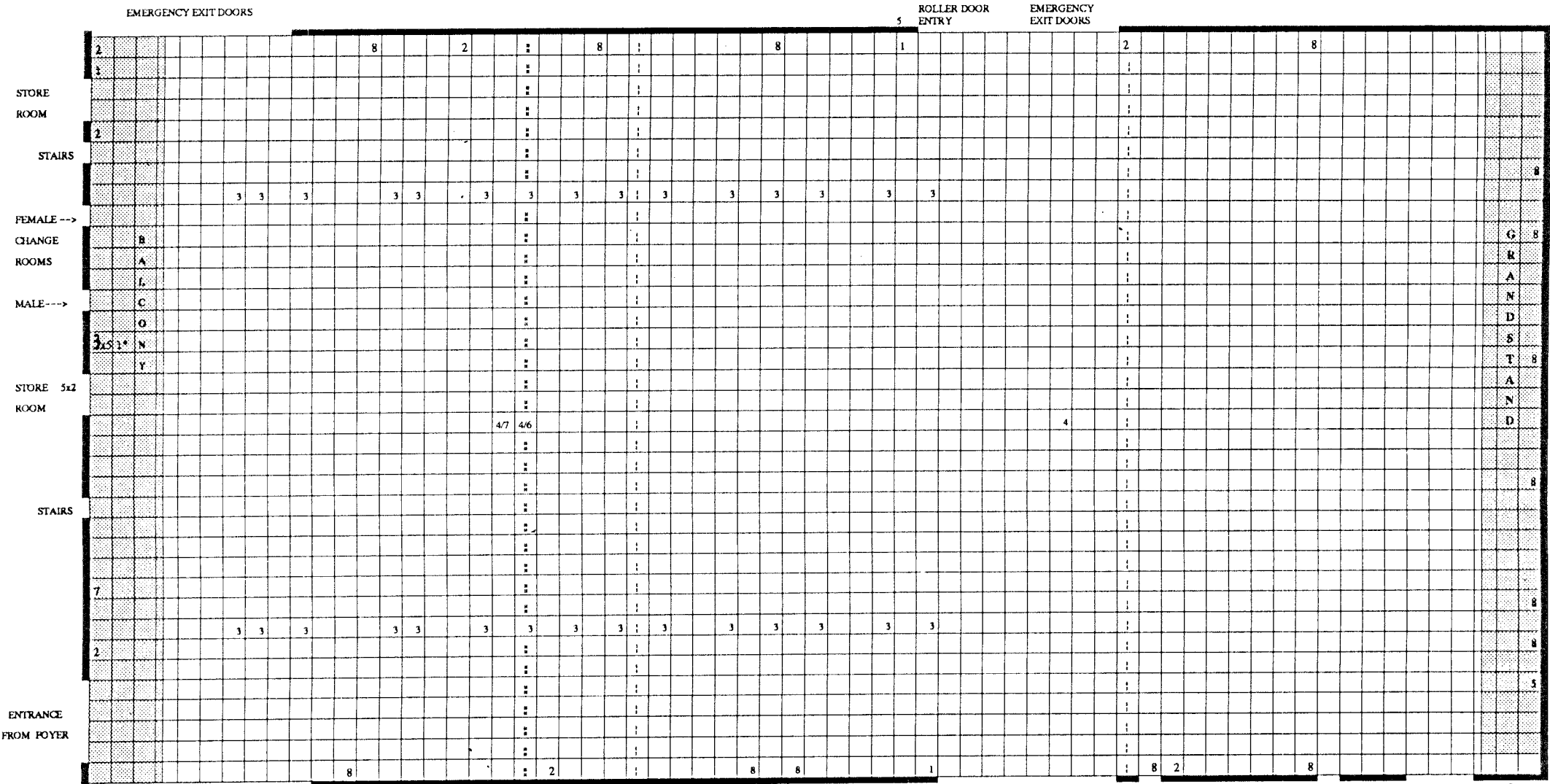

1	FIRE HOSE REELS
1*	FIRE HOSE REELS ON BALCONY
2	FLOOR POWER POINTS
3	CEILING POWER POINTS
4	SCORE BOARD INPUTS + POWER POINT
5	3 PHASE POWER POINTS
6	INPUT FOR MAIN PA SYSTEM
7	INPUT FOR SECOND PA SYSTEM
8	POWER POINTS ON LEDGE

MAIN GRANDSTAND - EXTENDED = 18m  
 PORTABLE GRANDSTAND EXTENDED = 30.5m X 7.5m  
 PORTABLE GRANDSTAND RETRACTED = 30.5m X 1.3m

EACH SQUARE IN FLOOR PLAN = 1 SQUARE METRE

